

Bowflag 100

- A. Flag
- B. Economy Bag (opt. Carrying Case available)
- C. Fiberglass and Aluminum Poles*
- D. Bungee Cord, Spring Snap, and Tensioner Set

* Amount of Pole components varies based on size of Bowflag

Size	Top Fiberglass Poles	Bottom Aluminum Poles
XXSmall	1	1
XSmall	2	1
Small	2	2
Medium	2	2
Large	2	2
XLarge	2	3

Wind Speed Recommendations:

- Bowflag 100 S/R: 24-30 mph (6bft)
- Bowflag 100 D/S: 13-18 mph (4bft)

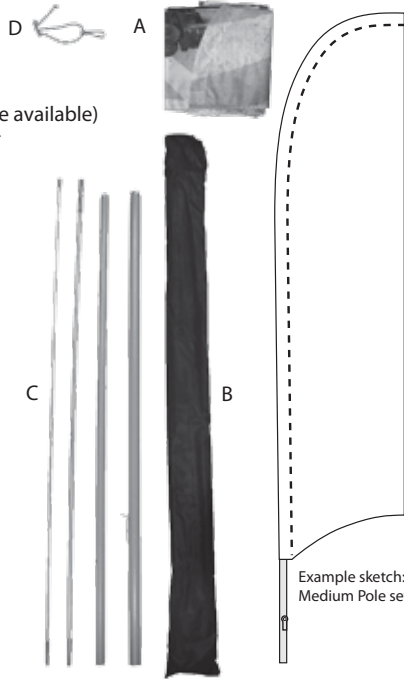

Bowflag 200

- A. Flag
- B. Economy Bag (opt. Carrying Case available)
- C. Aviation-grade Fiberglass Poles*
- D. Bungee Cord, Spring Snap, and Tensioner Set

* Amount of Pole components varies based on size of Bowflag

Size	Aviation-grade Fiberglass Poles
Medium	3
Large	3
XLarge	4

Wind Speed Recommendations:

- Bowflag 200 S/R: 55-63 mph (10bft)
- Bowflag 200 D/S: 39-46 mph (8bft)

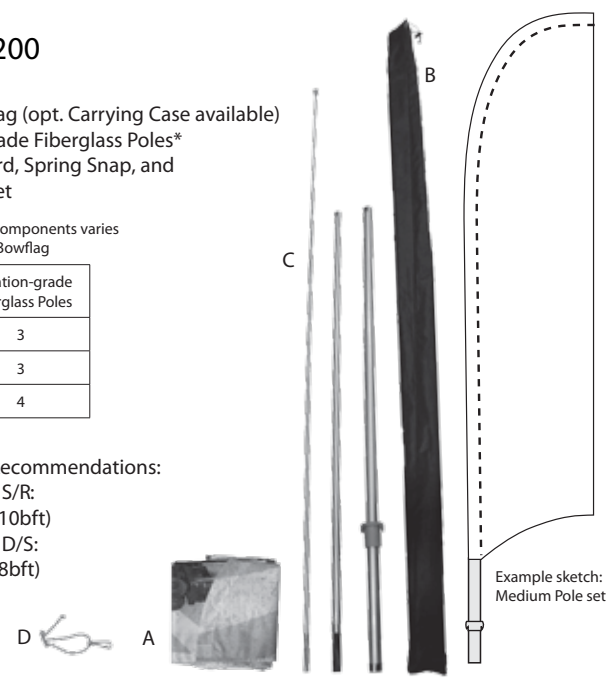

Before assembly, remove all components and confirm all pieces are included and are not damaged.

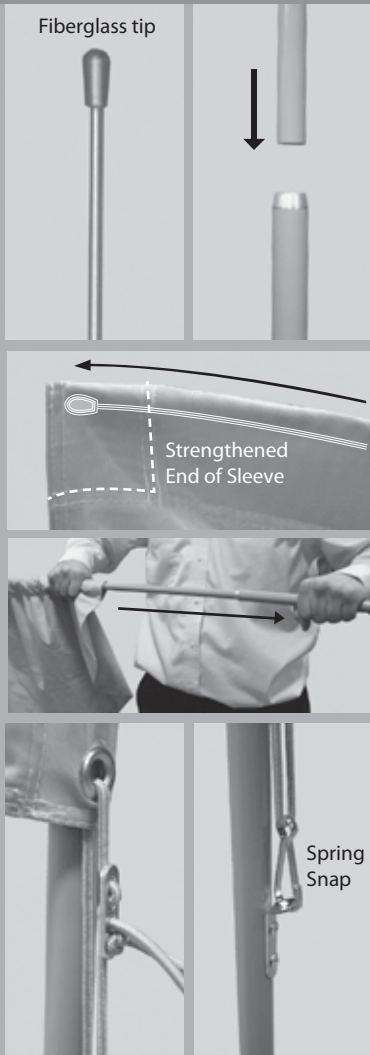

Bowflag 100

1. Lay all Poles (C) on ground and place in appropriate order before assembly.
2. Start assembly by sliding each Pole (C) together until snug. If poles are not fitting, try using the opposite side of the pole or changing the order of the poles. (There is only one correct order for each pole set)

3. Mount Flag (A) by inserting the top of the Fiberglass Pole (C) into the strengthened end of the sleeve. Slide flag down the Poles (C).

Note: Be certain the tip of the pole is fully inserted into the strengthened end of the sleeve. IF THIS IS NOT DONE CORRECTLY, FAILURE OF FLAG WILL RESULT AND ALL WARRANTIES WILL BE VOID!

4. Remove one end of the Bungee Cord (D) from the tensioner and place it through the grommet on the Flag (A). Continue by passing it through the Spring Snap before reattaching to the tensioner as shown in the picture to the left.

5. Pull the Bungee Cord (D) and attach the Spring Snap to the fastener on the Pole (C). Adjust the tensioner until the Flag (A) is taut.

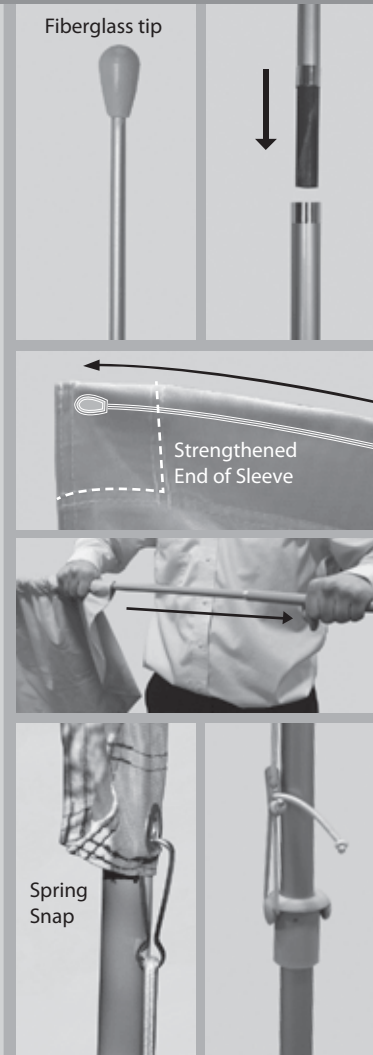

Bowflag 200

1. Lay all Poles (C) on ground and place in appropriate order before assembly.
2. Start assembly by sliding each Pole (C) together until snug. If poles are not fitting, try using the opposite side of the pole or changing the order of the poles. (There is only one correct order for each pole set)

3. Mount Flag (A) by inserting the top of the Fiberglass Pole (C) into the strengthened end of the sleeve. Slide flag down the Poles (C).

Note: Be certain the tip of the pole is fully inserted into the strengthened end of the sleeve. IF THIS IS NOT DONE CORRECTLY, FAILURE OF FLAG WILL RESULT AND ALL WARRANTIES WILL BE VOID!

4. Attach Spring Snap to the grommet on the Flag (A) and loop the Bungee Cord (D) around the fastener shown in the picture to the left.

5. Adjust the tensioner until the Print (A) is taut.



The Bowflags depicted herein have been wind tunnel tested in order to provide our customers with the most durable flag system, even when using double-sided flags.

Do not fly your Bowflag in extreme winds (any wind speed exceeding what is listed above) and/or thunderstorms. Do not use near overhead wires.

User must read and observe construction sheet. If this is not done correctly it may result in damage to the unit, injury, or death, and all warranties will be void.

