

INSTALLING THE BANNER - POLE MOUNT FRAME with TONGUE & GROOVE STYLE ARMS

NOTE: PLEASE KEEP THIS ON FILE FOR FUTURE BANNER CHANGES

Ins-I-BNR Rev 6/98

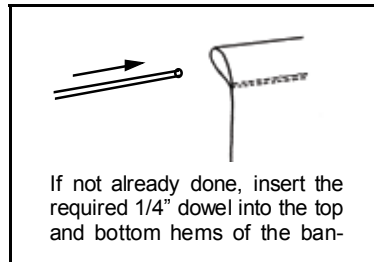
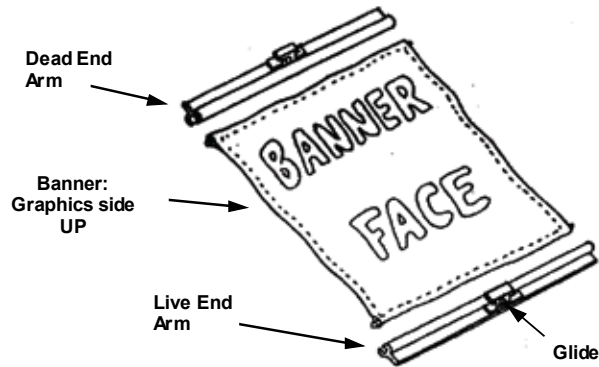

- 1** Lay out the banner, GRAPHICS SIDE UP, as shown. Lay out the **Dead End Arm** (green sticker) at the top of the banner, and the **Live End Arm** (red sticker) at the bottom. The **Glide** on each arm should be up, and the groove on each arm should point to the banner. Do not insert the **Tension Screw** just yet.

- 2** Slide the arms onto the banner exactly as shown. The dowel and material create the "tongue", which slide in to the "groove" in the arm. *If your banners are not made with the dowel, or if dowels are not included with your frame, call Voxpop Customer Service for assistance.*

- 3** Pick up the (top) **Dead Arm**. Fold it back so that the side with the **Glide** faces the pole. Drop its **Glide** into the top bracket.
- Turn the (bottom) **Live End Arm** under. Drop its **Glide** into the bottom bracket, and let it slide all the way down until it stops.
- The banner should conceal both arms.
- Insert the **Tension Screw** through the hole in the white plastic block in the bottom bracket, from the bottom up.

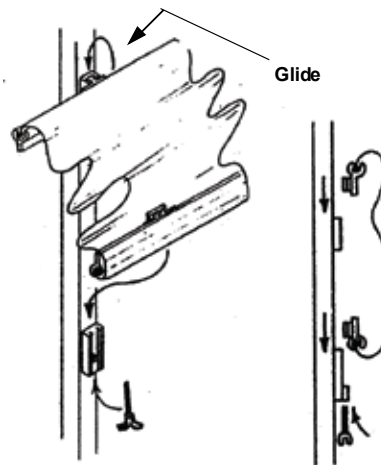

- 4** Squeeze a dab of grease onto 1-2" of the tip end of the **Tension Screw**.
- Thread the tip of the **Tension Screw** into the threaded hole in the **Glide** in the bottom arm.
- Wind the **Tension Screw** clockwise pulling the bottom arm gradually down, until the banner becomes taut.

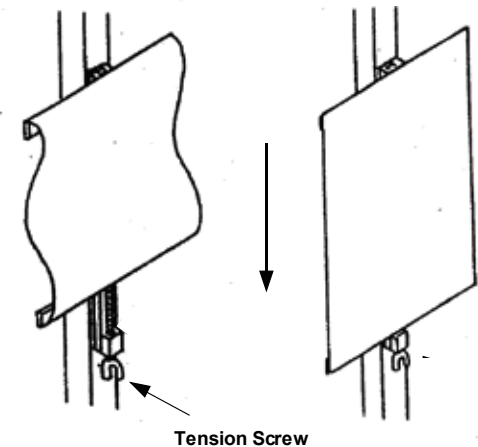

For Double-sided displays, repeat this procedure on both sides.

Manufactured in the USA by

VOXPOP
MARKETING SYSTEMS

10746 Worcester Highway P.O. Box 200
Berlin, MD 21811 800-386-9767
www.voxpopms.com

IMPORTANT NOTE !

The banner should conceal both arms. If it does not, reinstall. The display will not work properly unless both arms are concealed. The "groove" on the top arm should face up, and the "groove" on the bottom arm should face

TO REMOVE BANNER :

1. Unwind Tension Screw & remove.
2. Lift (top) Dead End Arm out of track.
3. Lift (bottom) Live End Arm out of track.
4. Remove both End Arms and Roller Strips from banner.